

OWNER'S STATEMENT

WE HEREBY STATE THAT WE ARE THE OWNERS OF, OR HAVE SOME RIGHT, TITLE OR INTEREST IN AND TO THE REAL PROPERTY INCLUDED WITHIN THE SUBDIVISION SHOWN UPON THIS MAP; AND THAT I/WE ARE THE ONLY PERSON(S) WHO/WHOSE CONSENT IS NECESSARY TO PASS CLEAR TITLE TO SAID PROPERTY; THAT I/WE HEREBY CONSENT TO THE PREPARATION AND FILING OF SAID MAP AND SUBDIVISION AS SHOWN WITHIN THE DISTINCTIVE BORDER LINE.

AS OWNER:

THE BOARD OF TRUSTEES OF THE LELAND STANFORD JUNIOR UNIVERSITY

SIGNATURE: _____

BY: _____

ITS: _____

OWNER'S ACKNOWLEDGMENT

A NOTARY PUBLIC OR OTHER OFFICER COMPLETING THIS CERTIFICATE VERIFIES ONLY THE IDENTITY OF THE INDIVIDUAL WHO SIGNED THE DOCUMENT TO WHICH THIS CERTIFICATE IS ATTACHED, AND NOT THE TRUTHFULNESS, ACCURACY, OR VALIDITY OF THAT DOCUMENT.

STATE OF CALIFORNIA

COUNTY OF _____)SS.

ON _____, 2025, BEFORE ME, _____, A NOTARY PUBLIC,

PERSONALLY APPEARED _____, WHO PROVED TO ME ON THE BASIS OF SATISFACTORY EVIDENCE TO BE THE PERSON(S) WHOSE NAME(S) IS/ARE SUBSCRIBED TO THE WITHIN INSTRUMENT AND ACKNOWLEDGED TO ME THAT HE/SHE/THEY EXECUTED THE SAME IN HIS/HER/THEIR AUTHORIZED CAPACITY(IES), AND THAT BY HIS/HER/THEIR SIGNATURE(S) ON THE INSTRUMENT THE PERSON(S), OR THE ENTITY UPON BEHALF OF WHICH THE PERSON(S) ACTED, EXECUTED THE INSTRUMENT.

I CERTIFY UNDER PENALTY OF PERJURY UNDER THE LAWS OF THE STATE OF CALIFORNIA THAT THE FOREGOING PARAGRAPH IS TRUE AND CORRECT.

WITNESS MY HAND.

NOTARY'S SIGNATURE: _____

PRINTED NOTARY'S NAME: _____

NOTARY'S PRINCIPAL PLACE OF BUSINESS: _____

NOTARY'S COMMISSION NO.: _____

EXPIRATION OF NOTARY'S COMMISSION: _____

FLOOD ZONE NOTE

THE PROPERTY LIES WITHIN FLOOD ZONE "X", BASED ON F.E.M.A. FLOOD INSURANCE RATE MAP, COMMUNITY PANEL NUMBER 06085C0017H, DATED MAY 18, 2009.

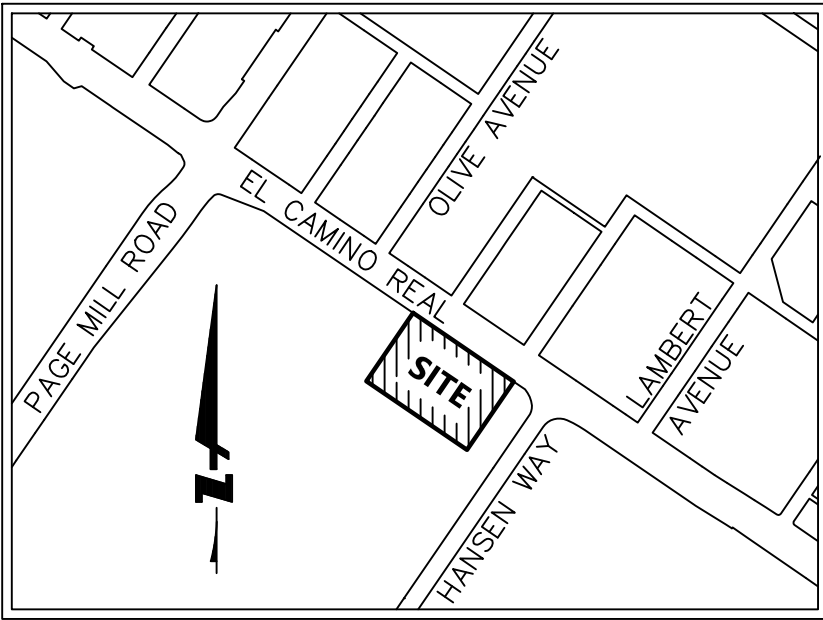

VICINITY MAP
NOT TO SCALE

DIRECTOR OF PLANNING AND DEVELOPMENT SERVICES

THIS FINAL MAP HAS BEEN EXAMINED THIS _____ DAY OF _____, 2025, AND FOUND TO CONFORM WITH THE APPROVED VESTING TENTATIVE MAP.

DATE: _____

BY: _____
JONATHAN LAIT, DIRECTOR OF
PLANNING AND DEVELOPMENT SERVICES
CITY OF PALO ALTO, CALIFORNIA

APPROVAL BY THE CITY COUNCIL

I, MAHEALANI AH YUN, CITY CLERK OF THE CITY OF PALO ALTO, SANTA CLARA COUNTY, CALIFORNIA, HEREBY CERTIFY THAT THE CITY COUNCIL OF SAID CITY OF PALO ALTO, AT IT'S REGULAR MEETING HELD ON THE _____ DAY OF _____, 2025, DULY APPROVED THE FINAL MAP AS SHOWN HEREON AND ACCEPT ON BEHALF OF THE PUBLIC THE ABANDONMENT OF THE PUBLIC EASEMENTS LISTED HEREON.

DATE: _____

BY: _____
MAHEALANI AH YUN
CITY CLERK
CITY OF PALO ALTO, CALIFORNIA

CITY ENGINEER'S STATEMENT

I HEREBY STATE THAT I HAVE EXAMINED THE WITHIN FINAL MAP; THAT THE SUBDIVISION AS SHOWN IS SUBSTANTIALLY THE SAME AS IT APPEARED ON THE VESTING TENTATIVE PARCEL MAP AND ANY APPROVED ALTERATIONS THEREOF, THAT ALL THE PROVISIONS OF THE SUBDIVISION MAP ACT AND ANY LOCAL ORDINANCES APPLICABLE AT THE TIME OF THE APPROVAL OF THE VESTING TENTATIVE PARCEL MAP HAVE BEEN COMPLIED WITH.

DATED: _____

BY: _____
BRADLEY EGGLESTON, R.C.E. 72158
DIRECTOR OF PUBLIC WORKS
EXPIRES: 6/30/2026

ABANDONMENT NOTE

PURSUANT TO SECTION 66434(g) OF THE SUBDIVISION MAP ACT, THE FILING OF THIS FINAL MAP CONSTITUTES THE ABANDONMENT OF THE EXISTING UTILITY EASEMENTS THAT AFFECT THE SUBJECT PROPERTY AS DESCRIBED IN THAT CERTAIN EASEMENT DOCUMENT RECORDED ON FEBRUARY 14, 1963 IN BOOK 5905, PAGE 218 OFFICIAL RECORDS OF SANTA CLARA COUNTY.

DATE: _____

CITY CLERK, CITY OF PALO ALTO

SURVEYOR'S STATEMENT

THIS MAP WAS PREPARED BY ME OR UNDER MY DIRECTION AND IS BASED UPON A FIELD SURVEY IN CONFORMANCE WITH THE REQUIREMENTS OF THE SUBDIVISION MAP ACT AND LOCAL ORDINANCE AT THE REQUEST OF THE BOARD OF TRUSTEES OF THE LELAND STANFORD JUNIOR UNIVERSITY IN OCTOBER 2025. I HEREBY STATE THAT ALL THE MONUMENTS ARE OF THE CHARACTER AND OCCUPY THE POSITIONS INDICATED OR THAT THEY WILL BE SET IN THOSE POSITIONS BEFORE DECEMBER, 2027, AND THAT THE MONUMENTS ARE, OR WILL BE, SUFFICIENT TO ENABLE THE SURVEY TO BE RETRACED, AND THAT THIS FINAL MAP SUBSTANTIALLY CONFORMS TO THE APPROVED OR CONDITIONALLY APPROVED VESTING TENTATIVE MAP.

DATED: _____

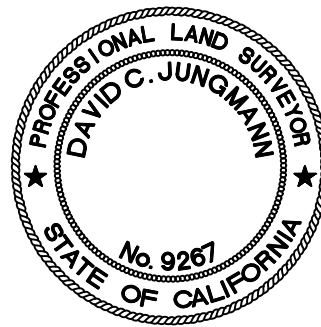

BY: _____
DAVID C. JUNGMANN
P.L.S. NO. 9267
EXPIRES: 6/30/2026

CITY SURVEYOR'S STATEMENT

I, MICHAEL E. LONG FOR THE CITY OF PALO ALTO, SANTA CLARA COUNTY, CALIFORNIA, DO HEREBY STATE THAT I HAVE EXAMINED THE WITHIN FINAL MAP AND I AM SATISFIED THAT THIS MAP IS TECHNICALLY CORRECT.

DATE: _____



BY: _____
MICHAEL E. LONG
P.L.S. 6815

COUNTY RECORDER'S STATEMENT

FILED THIS _____ DAY OF _____, 2025, AT: _____ A.M./P.M.
IN BOOK _____ OF MAPS, AT PAGES _____, SANTA CLARA COUNTY RECORDS, AT THE REQUEST OF THE BOARD OF TRUSTEES OF THE OF THE LELAND STANFORD JUNIOR UNIVERSITY.

LOUIS CHIARAMONTE, COUNTY RECORDER
SANTA CLARA COUNTY, CALIFORNIA

FILE NO.: _____

FEE: _____

BY: _____
DEPUTY RECORDER

FINAL MAP FOR LOT MERGER

BEING A LOT MERGER OF 3 PARCELS OF LAND, BEING THE LANDS OF THE BOARD OF TRUSTEES OF THE LELAND STANFORD JUNIOR UNIVERSITY, AS SAID LANDS ARE DESCRIBED IN THAT CERTAIN DOCUMENT, RECORDED ON _____ AS DOCUMENT NUMBER _____ SANTA CLARA COUNTY RECORDS, ALONG WITH THE LANDS OF THE BOARD OF TRUSTEES OF THE LELAND STANFORD JUNIOR UNIVERSITY, AS SAID LANDS ARE DESCRIBED IN THAT CERTAIN MEMORANDUM OF LEASE, RECORDED ON JULY 19, 1974 IN BOOK B001 AT PAGES 565 THROUGH 570, SANTA CLARA COUNTY RECORDS, AND OF THE LANDS THE BOARD OF TRUSTEES OF THE LELAND STANFORD JUNIOR UNIVERSITY, AS SAID LANDS ARE DESCRIBED IN THAT CERTAIN SURRENDER OF LEASEHOLD AGREEMENT, RECORDED ON FEBRUARY 2, 1984 IN BOOK 1277 AT PAGES 741 THROUGH 751, SANTA CLARA COUNTY RECORDS, SAID LAND ALSO BEING PARCEL C AS SHOWN ON THAT CERTAIN MAP ENTITLED "TRACT NO. 7506", FILED FOR RECORD ON FEBRUARY 9, 1984 IN BOOK 524 OF MAPS AT PAGE 31, IN THE OFFICE OF THE RECORDER OF SANTA CLARA COUNTY

PALO ALTO SANTA CLARA COUNTY CALIFORNIA
DECEMBER 2025

PREPARED BY



BKF ENGINEERS
255 SHORELINE DRIVE
SUITE 200
REDWOOD CITY, CA 94065
(650) 482-6300
www.bkf.com

